

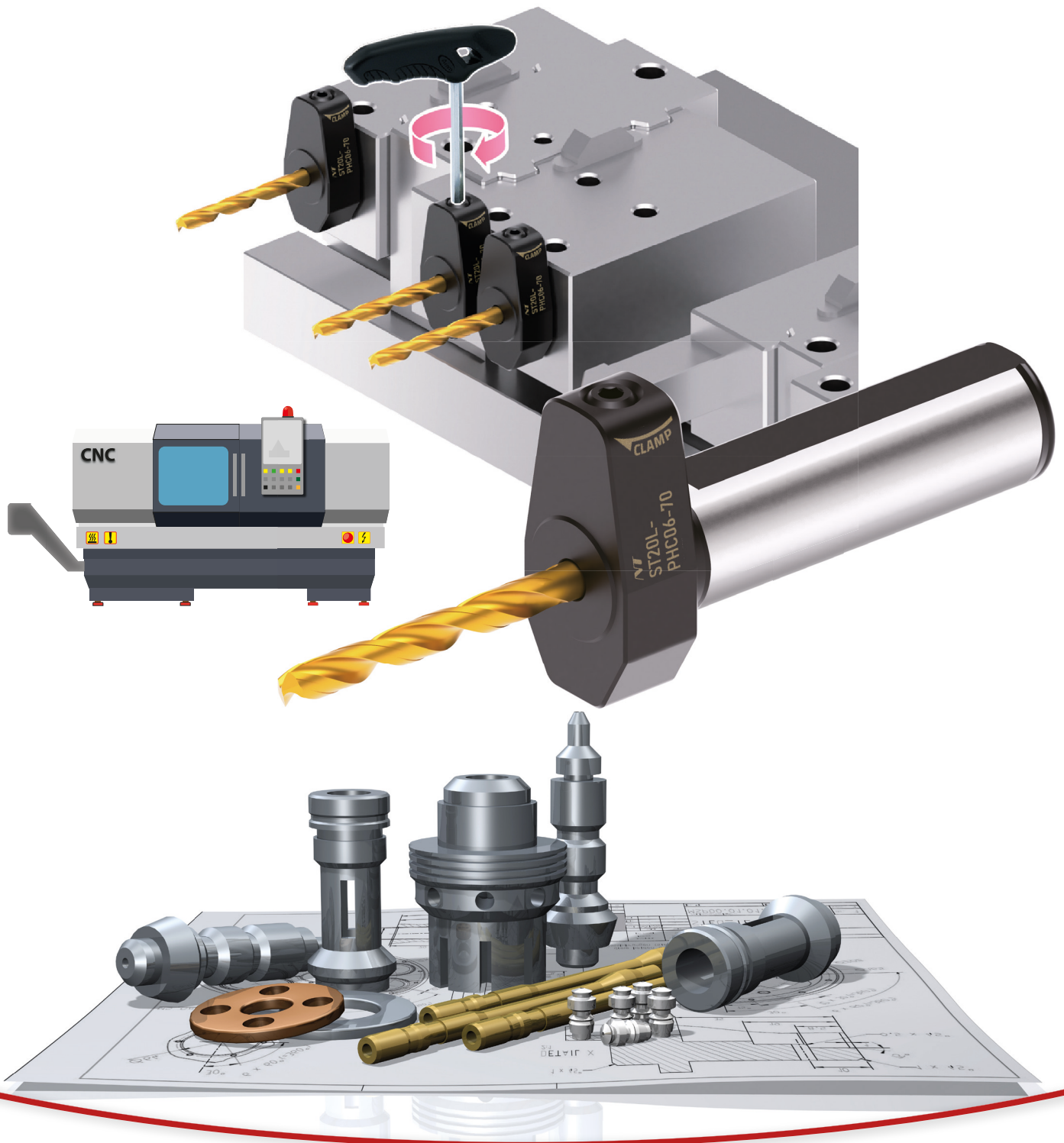

# ST·L-PHC

**NEW**

Hydro-TURNLine für CNC-Drehmaschinen  
Hydro-TURNLine for CNC automatic lathe



made by  **NT TOOL**  
[www.nttooleurope.com](http://www.nttooleurope.com)

NT TOOL EUROPE GmbH | Siemensstrasse 17A | D-61449 Steinbach | +49 (0)6171 91639-0 | info@nttooleurope.com



# ST·L-PHC

**NEW**

**Hydro-TURNLine für CNC-Drehmaschinen**  
Hydro-TURNLine for CNC automatic lathe

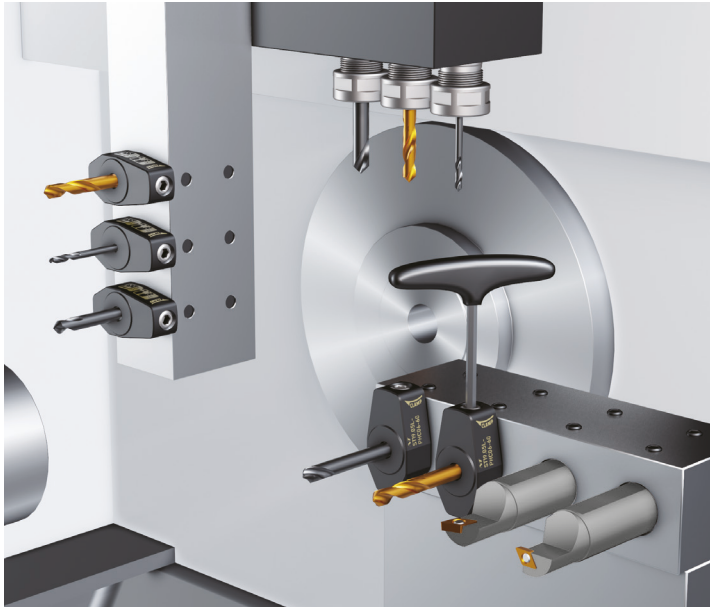

**Mehr Produktivität für Ihre Drehmaschine**  
More productivity for your lathe machine

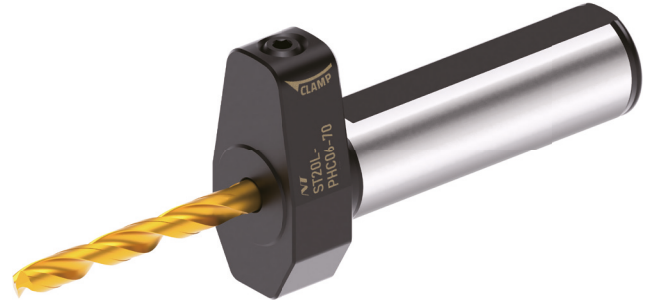

**Schaftauswahl** | shank size  
ST16L, ST19.05L, ST20L  
ST22L, ST25L, ST25.4L

**Spannbereich** | clamping range  
ø3.0 ~ ø12.0 mm

## Anwendungsbeispiel:

Rüstzeit um 80 % reduziert

## Application example:

set up time has been reduced by 80%!

### Vorher: Spannzungenaufnahme

Before: Collet Holder

Rüstzeit  
Set-up time **8 min 43 sec**

- ✗ **Umständliches Werkzeughandling**  
Tool change is difficult in tight spaces
- ✗ **erhöhter Rüstaufwand durch Höhenversatz**  
Tool pre-set with height offset
- ✗ **keine wiederholgenaue Werkzeugspannung**  
Accuracy varies between tool changes

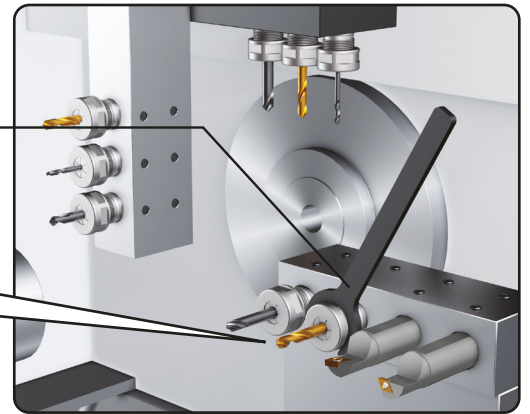
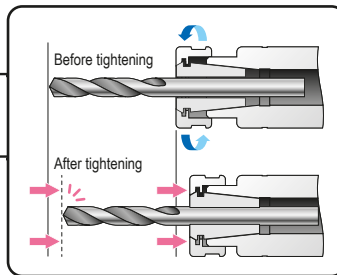

### HYDRO-TURNLine

Rüstzeit  
Set-up time **1 min 38 sec**

- ✓ **einfaches Spannhandling**  
Easy chucking with a single wrench
- ✓ **Voreinstellung ohne Höhenversatz**  
Tool pre-set without height offset
- ✓ **Wiederholgenauigkeit**  
Good repeatability (1µm)
- ✓ **erhöhte Standzeit durch Vibrationsdämpfung**  
Anti-vibration effect provides longer tool life

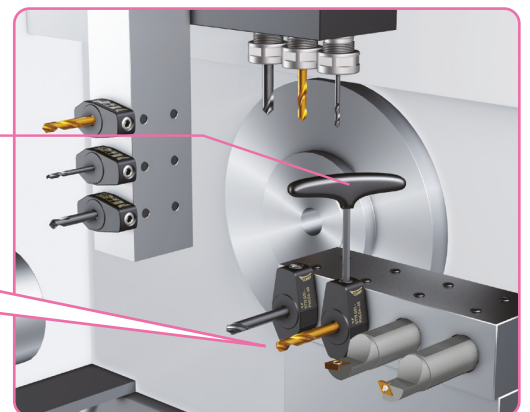
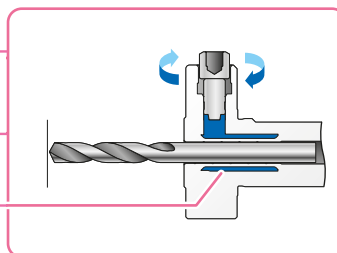



# ST·L-PHC

**NEW**

**Hydro-TURNLine für CNC-Drehmaschinen**  
Hydro-TURNLine for CNC automatic lathe

**Type1**

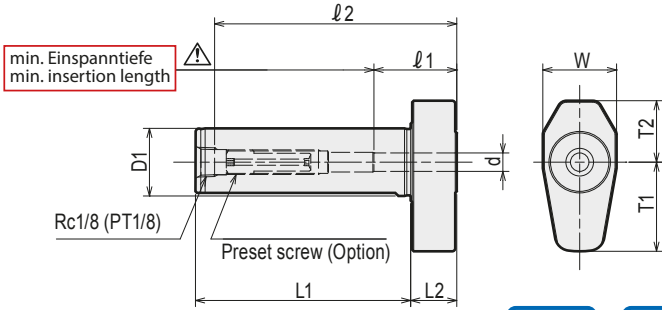

**Type2**

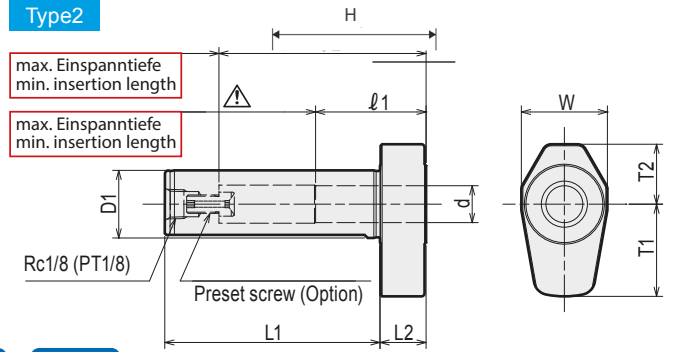

**Tol. h6**



Halter   Holder	Type	d	D1	L1	L2	W	T1	T2	l1	l2	
<b>ST16L</b> -PHC03 -50	1	3	16	50	15	22	23	17.5	16	58	L-4T
	1	4	16	50	15	22	23	17.5	19	58	
	1	6	16	50	15	22	24.5	18.5	27	58	
	2	8	16	50	15	24	25.5	19.5	27	47	
<b>ST19.05L</b> -PHC03 -60	1	3	19.05	60	15	22	23	17.5	16	68	L-4T
	1	4	19.05	60	15	22	23	17.5	19	68	
	1	6	19.05	60	15	22	24.5	18.5	27	68	
	2	8	19.05	60	15	24	25.5	19.5	27	57	
	2	10	19.05	60	15	26	26.5	20.5	33	60	
<b>ST20L</b> -PHC03 -70	1	3	20	70	15	22	23	17.5	16	78	L-4T
	1	4	20	70	15	22	23	17.5	19	78	
	1	6	20	70	15	22	24.5	18.5	27	78	
	2	8	20	70	15	24	25.5	19.5	27	64	
	2	10	20	70	15	26	26.5	20.5	33	67	
<b>ST22L</b> -PHC03 -70	1	3	22	70	15	24	23	17.5	16	78	L-4T
	1	4	22	70	15	24	23	17.5	19	78	
	1	6	22	70	15	24	24.5	18.5	27	78	
	2	8	22	70	15	24	25.5	19.5	27	64	
	2	10	22	70	15	26	26.5	20.5	33	67	
	2	12	22	70	15	28	29	21.5	36	67	
<b>ST25L</b> -PHC03 -70	1	3	25	70	15	28	23	17.5	16	78	L-4T
	1	4	25	70	15	28	23	17.5	19	78	
	1	6	25	70	15	28	24.5	18.5	27	78	
	2	8	25	70	15	28	25.5	19.5	27	64	
	2	10	25	70	15	28	26.5	20.5	33	67	
	2	12	25	70	15	28	29	21.5	36	67	
<b>ST25.4L</b> -PHC03 -70	1	3	25.4	70	15	28	23	17.5	16	78	L-4T
	1	4	25.4	70	15	28	23	17.5	19	78	
	1	6	25.4	70	15	28	24.5	18.5	27	78	
	2	8	25.4	70	15	28	25.5	19.5	27	64	
	2	10	25.4	70	15	28	26.5	20.5	33	67	
	2	12	25.4	70	15	28	29	21.5	36	67	

**⚠ ACHTUNG:** beachten Sie die Mindesteinspanntiefe

**⚠ CAUTION:** Strictly keep the min insertion length.

**Bestellbeispiel | Ordering Example**

**ST16L - PHC03 - 50**

# Spannhülsen für PHC12 | Straight Collets for PHC12

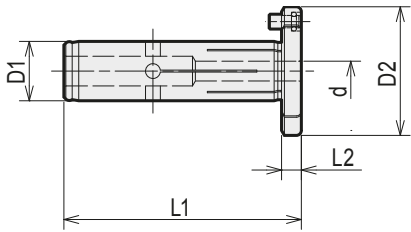

Halter Holder	Hülse   Collet	D1	D2	L1	L2	d
PHC12	PHS12 - <b>d</b> - OH	12	26	48	4	03, 04, 05, 06, 07, 08, 09, 10
	PHS12 - <b>d</b> - C	12	26	48	4	03, 04, 05, 06, 07, 08, 09

**PHS-OH:** für innere Kühlmittelzufuhr | for inner coolant

**PHS-C:** für periphere Kühlmittelzufuhr | for side-through coolant

## Einstellschrauben | Preset Screw

Type1

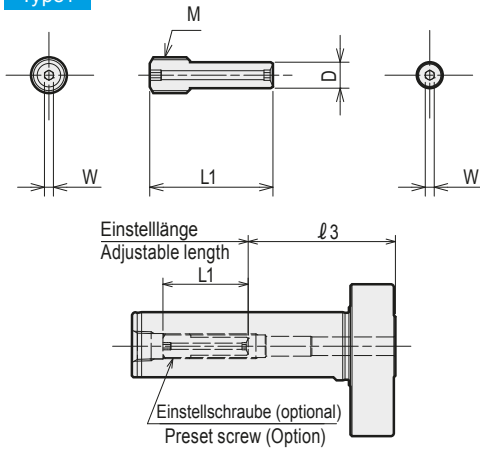

Schraube   Screw	Type	L1	L2	D	W	M	Halter   Holder
PHCL-P04-27.5	1	27.5	—	3.8	2	M8 P=1.25	PHC03 PHC04
PHCL-P06-27.5	1	27.5	—	5.8	2		PHC06
PHCL-P08-15.5	2	15.5	5	7.8	2		PHC08 PHC10 PHC12
PHCL-P08-20.5	2	20.5	10	7.8	2		
PHCL-P08-25.5	2	25.5	15	7.8	2		
PHCL-P08-30.5	2	30.5	20	7.8	2		
PHCL-P08-35.5	2	35.5	25	7.8	2		
PHCL-P08-40.5	2	40.5	30	7.8	2		

Bestellbeispiel | Ordering Example

**PHCL - P04 - 27.5**

Type2

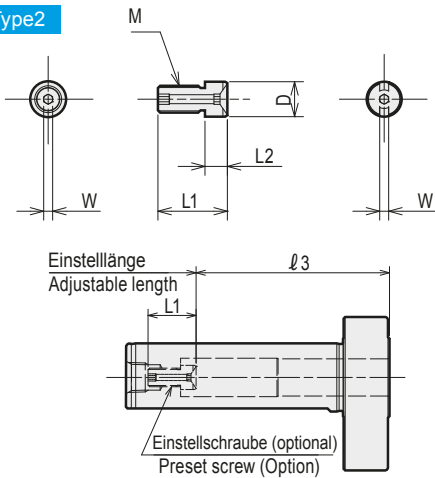

## Einstelllänge | Adjustment amount

Schraube   Screw	passend für Matched chuck	Type	L1	l3
PHCL-P04-27.5	ST16L - PHC03 - 50	1	27.5	17 ~ 30
	- PHC04 - 50	1	27.5	19 ~ 30
	ST19.05L - PHC03 - 60	1	27.5	17 ~ 40
	- PHC04 - 60	1	27.5	19 ~ 40
	ST20L - PHC03 - 70	1	27.5	17 ~ 50
	- PHC04 - 70	1	27.5	19 ~ 50
PHCL-P06-27.5	ST22L - PHC03 - 70	1	27.5	17 ~ 50
	- PHC04 - 70	1	27.5	19 ~ 50
	ST16L - PHC06 - 50	1	27.5	27 ~ 30
	ST19.05L - PHC06 - 60	1	27.5	27 ~ 40
	ST20L - PHC06 - 70	1	27.5	27 ~ 50
	ST22L - PHC06 - 70	1	27.5	27 ~ 50

Schraube   Screw	passend für Matched chuck	Type	L1 = 15.5	L1 = 20.5	L1 = 25.5	L1 = 30.5	L1 = 35.5	L1 = 40.5
			PHCL-P08- <b>L1</b>	ST16L - PHC08 - 50	2	35 ~ 42	30 ~ 37	27 ~ 32
	ST19.05L - PHC08 - 60	2	45 ~ 52	40 ~ 47	35 ~ 42	30 ~ 37	27 ~ 32	—
	ST19.05L - PHC10 - 60	2	49 ~ 52	44 ~ 47	39 ~ 42	34 ~ 37	—	—
	ST20L - PHC08 - 70	2	52 ~ 59	47 ~ 54	42 ~ 49	37 ~ 44	32 ~ 39	27 ~ 34
	ST19.05L - PHC10 - 70	2	56 ~ 62	51 ~ 57	46 ~ 52	41 ~ 47	36 ~ 42	33 ~ 37
	ST22L - PHC08 - 70	2	52 ~ 59	47 ~ 54	42 ~ 49	37 ~ 44	32 ~ 39	27 ~ 34
	ST19.05L - PHC10 - 70	2	56 ~ 62	51 ~ 57	46 ~ 52	41 ~ 47	36 ~ 42	33 ~ 37
	ST19.05L - PHC12 - 70	2	56 ~ 62	51 ~ 57	46 ~ 52	41 ~ 47	36 ~ 42	—
	ST25L - PHC08 - 70	2	52 ~ 59	47 ~ 54	42 ~ 49	37 ~ 44	32 ~ 39	27 ~ 34
	ST19.05L - PHC10 - 70	2	56 ~ 62	51 ~ 57	46 ~ 52	41 ~ 47	36 ~ 42	33 ~ 37
	ST19.05L - PHC12 - 70	2	56 ~ 62	51 ~ 57	46 ~ 52	41 ~ 47	36 ~ 42	—
	ST25.4L - PHC08 - 70	2	52 ~ 59	47 ~ 54	42 ~ 49	37 ~ 44	32 ~ 39	27 ~ 34
	ST19.05L - PHC10 - 70	2	56 ~ 62	51 ~ 57	46 ~ 52	41 ~ 47	36 ~ 42	33 ~ 37
	ST19.05L - PHC12 - 70	2	56 ~ 62	51 ~ 57	46 ~ 52	41 ~ 47	36 ~ 42	—